

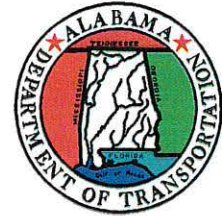

ALABAMA
DEPARTMENT OF TRANSPORTATION



KAY IVEY
GOVERNOR

SOUTHWEST REGION – DISTRICT 2
OFFICE OF DISTRICT ENGINEER
47450 RABUN ROAD
BAY MINETTE, ALABAMA 36507
TELEPHONE: (251) 937-2086
FAX (251) 937-8475

JOHN R. COOPER
TRANSPORTATION DIRECTOR

February 18, 2021

Baldwin County
105 W. 3rd St
Bay Minette, AL 36507

Dear Sir:

RE: Permit Number: 9-2-11747
Baldwin County

Permit Expiration Date: February 18, 2022

Attached please find an approval for the directional bore installation of a 1.5" HDPE conduit with communications cable and placement of (1) hand hole along/across SR-287 from MP 0.04 to MP 0.14, as shown in attached plans.

Performance of this work shall be done in accordance with all current requirements of the Alabama Department of Transportation. It is required a print of the approved drawings, bearing my stamp signature, be on the jobsite throughout the time of installation. During the installation of this permitted utility work, all traffic control devices shall be in accordance with the MANUAL ON UNIFORM TRAFFIC CONTROL DEVICES – PART VI, 2009 EDITION. All work performed under this permit shall comply with current EPA and ADEM policies.

Mr. David M. Styron II, District Administrator, will administer the inspection for the Alabama Department of Transportation. It is required you contact him at least 48 hours prior to beginning work. Upon completion of the work, please notify him in writing requesting a final inspection. His address is 47450 Rabun Road, Bay Minette, Alabama 36507. His telephone number is (251) 937-2086.

Sincerely,

MATTHEW ERICKSEN, P.E., REGION ENGINEER

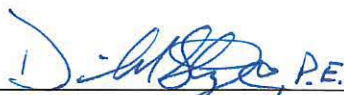
By: 
David M. Styron II, P.E.
District Administrator

DMS/dr
Attachment
c: Mr. Jason Shaw, P.E. Maintenance Engineer-Mobile
Stacey N. Glass, P.E.
File

ALABAMA DEPARTMENT OF TRANSPORTATION
PERMIT AGREEMENT FOR THE ACCOMMODATION OF UTILITY
FACILITIES ON PUBLIC RIGHT-OF-WAY

County Baldwin

Route Number State Route 287 (Hand Ave)

Milepost MP 0.04 to MP 0.14

Bonding Agency None

Bond Number Waived

Associated Permits and/or Documents Best management practice and directional bore procedure documents.

FOR OFFICIAL USE ONLY

DATE RECEIVED FROM APPLICANT: 02/08/2021

PERMIT NUMBER: 9-2-11747

THIS AGREEMENT is entered into this the 2nd day of February, 2021, by and between the Alabama Department of Transportation acting by and through its Transportation Director hereinafter referred to as ALDOT and Baldwin County, a Utility hereinafter referred to as the APPLICANT.

WITNESSETH

WHEREAS, the APPLICANT desires to have its facilities accommodated on public highway right-of-way in Baldwin County, Alabama consisting approximately of the following:
Placement of buried (1) 1.5" HDPE containing 96 Count Fiber Optic Cable, said placement to be made by means of directional boring in the back of Right-of-Way along Alabama Highway 287 (Hand Ave) in the City of Bay Minette.

_____ ; and

WHEREAS, ALDOT hereby grants to the APPLICANT approval to cross or locate its facilities on the public right-of-way at the location and in the manner hereinafter set forth:

NOW, THEREFORE, it is agreed by and between the parties hereto as follows:

1. The APPLICANT will install its facilities on public right-of-way in accordance with plans and specifications of the APPLICANT as approved by ALDOT which plans and specifications are hereby made a part of this permit by reference.
2. In the installation of facilities and performing work under this agreement, the APPLICANT will conform to the provisions of the latest edition of the Alabama Department of Transportation Utility Manual, which manual is of record in ALDOT and is hereby made a part of this permit by reference.
3. The national Manual on Uniform Traffic Control Devices, ALDOT approved edition, is hereby made a part of this permit by reference and will be conformed to as the provisions thereof are applicable to such work. Such Manual is of record in ALDOT at the execution of this Agreement.

4. The Federal Water Pollution Control Act, The Federal Insecticide, Fungicide, and Rodenticide Act, The Alabama Water Pollution Control Act, The Alabama Environmental Management Act, The Clean Water Act (1987), and the Alabama Nonpoint Source Management Program (1989) are hereby made a part of this permit by reference.

5. The APPLICANT will conform to the regulations of the Environmental Protection Agency (EPA) and of the Alabama Department of Environmental Management (ADEM), latest edition, for both installation and maintenance of such facilities.

The APPLICANT will provide proof of applicable permit coverage and conform to the above referenced regulations for both the facility installation and maintenance of permitted facilities and areas of rights-of-way. The APPLICANT must provide a copy of the Notice of Intent (NOI) issued by ADEM. This will assure compliance with Phase II of storm-water construction requirements. In the event a NOI is not required, APPLICANT must submit to ALDOT a Best Management Practices (BMP) plan to control sediment run-off.

6. In the event that ALDOT is issued a citation or any other enforcement document by ADEM/EPA for failure to comply with applicable requirements, it shall be the responsibility of the APPLICANT to bring all BMPs into compliance and to pay for any fines, assessments, etc. that may be issued to ALDOT by ADEM/EPA.

7. Underground Damage Prevention Legislation, Alabama Act 94-487, is hereby made a part of this permit by reference. The APPLICANT will conform to the above referenced regulations for both the facility installation and maintenance of permitted facilities and areas of rights-of-way. Should the permitted work require a locate request ticket, no work shall begin until a copy of such ticket is obtained and the APPLICANT shall keep a copy of such ticket at the site of work.

8. If hazardous materials, wastes, substances, or as otherwise defined by Code of Alabama § 6-5-332.1(a)(2) (1993 Repl. Vol.) are encountered in the execution of this Agreement it will be the responsibility of the APPLICANT to notify the proper agency responsible for said hazardous materials and to comply with any and all environmental regulations as established by the Environmental Protection Agency (EPA), Alabama Department of Environmental Management (ADEM), and of the Occupational Safety and Health Administration (OSHA) in the proper disposition of the hazardous materials encountered.

9. This permit is valid for the contract period which is defined as follows: All proposed work as described and submitted in the permit documents must be completed within one year from the approved date of the permit and for a period covering one year from ALDOT acceptance of proposed work.

10. The APPLICANT will perform or cause to be performed the work applied for in this permit contract and will restore the highway in the work area in as good condition as the same was prior to the work and will maintain the accomplished work and highway work area in a condition satisfactory to ALDOT. Should the APPLICANT not maintain the work or create an unsafe condition during the contract period, ALDOT reserves the right to remove any work and restore the ROW to a safe condition at the expense of the APPLICANT and the APPLICANT agrees to pay ALDOT all such costs as a result.

11. Once work is begun, the APPLICANT shall pursue the work continuously and diligently until completion. Should the APPLICANT feel that the work cannot be completed in a one year period, they shall submit in writing (30 days prior to the termination date) to ALDOT the reasons for an extension of time. ALDOT will determine whether an extension may be approved.

12. The APPLICANT will file with ALDOT an acceptable certified check or bond in the penal amount of \$ Waived (Bond Number: Waived) to guarantee the faithful performance of this permit contract in its entirety during the contract period as defined in item 9. Upon satisfactory completion and acceptance of all work provided for in this permit contract, the check or bond, as applicable, will be returned to the APPLICANT; otherwise, the proceeds from the check, or any amount received by ALDOT as a result of the bond, will be applied to complete and fulfill the permit contract terms. In the instance that ALDOT determines a bond on record is necessary, the APPLICANT shall provide such bond to ALDOT. The bond amount shall be determined by ALDOT.

13. Indemnification Provisions. Please check the appropriate type of applicant:

By entering into this agreement, the APPLICANT is not an agent of the State, its officers, employees, agents or assigns. The APPLICANT is an independent entity from the State and nothing in this agreement creates an agency relationship between the parties.

If the applicant is an incorporated municipality or gas district then:

Subject to the limitations on damages applicable to municipal corporations under Ala. Code § 11-47-190 (1975), the APPLICANT shall defend, indemnify, and hold harmless the State of Alabama, ALDOT, its officers, officials, agents, servants, and employees, in both their official and individual capacities, from and against (1) claims, damages, losses, and expenses, including but not limited to attorneys' fees arising out of, connected with, resulting from or related to the work performed by the APPLICANT, or its officers, employees, contracts, agents or assigns (2) the provision of any services or expenditure of funds required, authorized, or undertaken by the APPLICANT pursuant to the terms of this Agreement, or (3) any damage, loss, expense, bodily injury, or death, or injury or destruction of tangible property (other than the work itself), including loss of use therefrom, and including but not limited to attorneys' fees, caused by the negligent, careless or unskillful acts of the APPLICANT its agents, servants, representatives or employees, or the misuse, misappropriation, misapplication, or misexpenditure of any source of funding, compensation or reimbursement by the APPLICANT, its agents, servants, representatives or employees, or anyone for whose acts the APPLICANT may be liable.

If the applicant is county government then:

The APPLICANT shall be responsible at all times for all of the work performed under this agreement and, as provided in Ala. Code § 11-93-2 (1975), the APPLICANT shall protect, defend, indemnify and hold harmless the State of Alabama, The Alabama Department of Transportation, its officials, officers, servants, and employees, in both their official and individual capacities, and their agents and/or assigns.

For all claims not subject to Ala. Code § 11-93-2 (1975), the APPLICANT shall indemnify and hold harmless the State of Alabama, the Alabama Department of Transportation, the officials, officers, servants, and employees, in both their official and individual capacities, and their agents and/or assigns from and against any and all action, damages, claims, loss, liabilities, attorney's fees or expense whatsoever or any amount paid in compromise thereof arising out of, connected with, or related to the (1) work performed under this Agreement, (2) the provision of any services or expenditure of funds required, authorized, or undertaken by the APPLICANT pursuant to the terms of this agreement, or (3) misuse, misappropriation, misapplication, or misexpenditure of any source of funding, compensation or reimbursement by the APPLICANT, its agents, servants, representatives, employees or assigns.

If the applicant is a state governmental agency or institution then:

The APPLICANT shall be responsible for damage to life and property due to activities of the APPLICANT of employees of APPLICANT in connection with the work or services under this Agreement. The APPLICANT agrees that its contractors, subcontractors, agents, servants, vendors or employees of APPLICANT shall possess the experience, knowledge and skill necessary to perform the particular duties required or necessary under this Agreement. The APPLICANT is a state institution and is limited by the Alabama Constitution in its ability to indemnify and hold harmless another entity. The APPLICANT maintains self-insurance coverage applicable to the negligent acts and omissions of its officers and employees, which occur within the scope of their employment by the APPLICANT. The APPLICANT has no insurance coverage applicable to third-party acts, omissions or claims, and can undertake no obligation that might create a debt on the State Treasury. The APPLICANT agrees ALDOT shall not be responsible for the willful, deliberate, wanton or negligent acts of the APPLICANT, or its officials, employees, agents, servants, vendors, contractors or subcontractors. The APPLICANT shall require, its contractors and its subcontractors, agents, servants or vendors, as a term or its contract with the APPLICANT, to include ALDOT as an additional insured in any insurance policy providing coverage for the work to be performed pursuant to and under this Agreement and to provide the APPLICANT a copy of the insurance policy declaration sheet confirming the addition of ALDOT thereto.

If the applicant is not a county, incorporated municipality, or state governmental agency or institution then:

The APPLICANT will protect, defend, indemnify and hold harmless the State of Alabama, ALDOT, the officials, officers, and employees, in both their official and individual capacities, and their agents and/or assigns, from and against any and all actions, damages, claims, loss, liabilities, attorney's fees or expense whatsoever or any amount paid in compromise thereof arising out of or connected with the work performed under this Permit, and/or the APPLICANT's failure to comply with all applicable laws or regulations.

14. The APPLICANT will be obligated for the payment of damages occasioned to private property, public utilities or the general public, caused by the legal liability (in accordance with Alabama and/or Federal law) of the APPLICANT, its agents, servants, employees or facilities.

15. ALDOT in executing this Agreement does not in any way assume the responsibility for the maintenance of the facilities of the APPLICANT, nor the responsibility for any damage to the facilities caused by third parties.

16. The APPLICANT will have a copy of this Agreement on the project site at all times while said work is being performed.

17. Nothing contained in this Permit Agreement, nor the issuance or receipt thereof, shall be construed to alter or affect the title of ALDOT to the public right-of-way nor to increase, decrease or modify in any way the rights of the APPLICANT provided by law with respect to the construction, operation or maintenance of its facilities on the public right-of-way.

18. Reimbursement for future relocations of the APPLICANT'S facilities will be in accordance with State law in effect at the time such relocations are made.

19. The APPLICANT stipulates that the specific use of these facilities located upon public right-of-way is to expand an county-wide communications fiber optic ring to the new jail edition and annex. The APPLICANT further stipulates that should this specific use change at any time in the future that the APPLICANT will notify ALDOT immediately of the change.

This Agreement is deemed to be executed on the date hereinabove set forth by the parties hereto in their respective names by those persons and officials thereunto duly authorized. Witness our hands and seals, this the 2nd day of February, 2021.

WITNESS:

[Handwritten Signature]

Baldwin County

Legal Name of Applicant

By: [Handwritten Signature]
Chairman
Authorize Signature and Title for Applicant

Typed or Printed Name of Signee

105 W. Third Street

Address Line 1

Bay Minette, AL 36507

Address Line 2

251-580-2598

Telephone Number

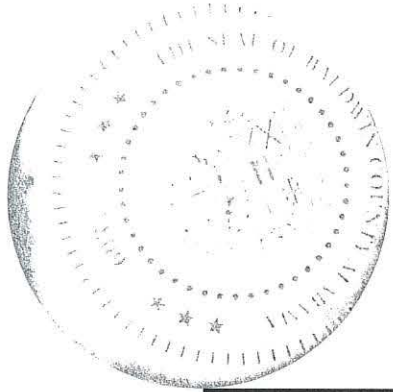

FOR OFFICIAL USE ONLY

RECOMMENDED FOR APPROVAL:

DISTRICT:	_____	_____	_____
	Printed Name	Signature	Date
AREA:	_____	_____	_____
	Printed Name	Signature	Date
REGION:	_____	_____	_____
	Printed Name	Signature	Date

APPROVED:
ALABAMA DEPARTMENT OF TRANSPORTATION
ACTING BY AND THROUGH ITS TRANSPORTATION
DIRECTOR

(PLEASE CHECK APPROPRIATE BOX)

- CENTRAL OFFICE
- REGION
- AREA
- DISTRICT

By: <u>Matthew Erickson, P.E.</u>	<u>[Handwritten Signature]</u>	<u>2/18/2021</u>
Printed Name	Signature	Date

BORING PROCEDURE FOR ALDOT RIGHT-OF-WAY

Utility Name: Baldwin County
Bore Location: AL SR 287 (Hand Ave)
Permit No.: _____

- A. **ENVIRONMENTAL PROTECTION:** Before any work is begun on ALDOT right-of-way, the contractor shall install erosion control devices which meet current ALDOT standards and specifications. Additional environmental protection necessary to contain any hydraulic or boring fluid spills shall be installed, including berms, liners, turbidity curtains and other measures. Contractor shall adhere to all applicable environmental regulations. Fuel or oil may not be stored in bulk containers within 200' of any water-body or wetland.
- B. **UTILITY LOCATES:** Contractor shall notify all companies with underground utilities in the work area via the State or Local "One Call" to obtain utility locates. Contractor shall not begin work until all underground utilities within the work area have been located.
- C. **SAFETY:** Contractor shall adhere to all State, Federal, and Local Safety regulations and all operations shall be conducted in a safe manner.
- D. **DRILLING FLUIDS:** A solution marketed as EZ MUD will be used as a boring lubricant during the boring process. Per manufacturers recommendations the lubricant can be injected into the operation at a maximum rate of 14 Gallons per minute. Actual operating injection rate shall be 14 gallons per minute. A solution marketed as QUICK-GEL will be used as a sealant to support any unstable soil encountered during the bore application. Per manufacturers recommendation the sealant can be injected at the maximum rate of 250 pounds per square inch. Actual operating pressure shall be 250 pounds per square inch.
- E. **DRILLING EQUIPMENT:** The drilling machine to be used in this operation will be manufactured by VERMEER, model 24 x 40. The machine has a maximum operating thrust of 24,000 pounds and a maximum pull back of 24,000 pounds. The automatic locating system will be a DCI-F5 which will allow the operator and spotter to maintain depth and grade at all times.
- F. **PILOT HOLE:** A 3 inch Pilot hole shall be drilled on bore path at or greater than the required minimum depth over a length of 100'. In the event that pilot does deviate from the bore path resulting in a bore depth less than the required minimum the contractor will notify the Engineer and the Engineer may require the contractor to pull back and re-drill from the location along the bore path before the deviation.
- G. **REAMING:** Upon successful completion of the pilot hole, the contractor will ream the bore hole to a NA inch diameter using a NA inch reaming head and if necessary repeat with a NA inch reaming head to achieve the desired hole diameter needed to accommodate the required encasement pipe.
- H. **BORE:** All bores will begin and end a minimum of 3' beyond the toe-of-ditch and below the ditch elevation to achieve the minimum required cover within the right-of-way. The depth and direction of the bore will be tracked during the process by electronic detection of the bore head. The encasement will be plugged with duct sealing compound. This compound will be comprised of non-hazardous compounds.
- I. Any deviations from the above mentioned requirements will be covered with the ALDOT District Manager prior to the start of construction.

TRAFFIC CONTROL PLAN

WORK BEYOND THE SHOULDER

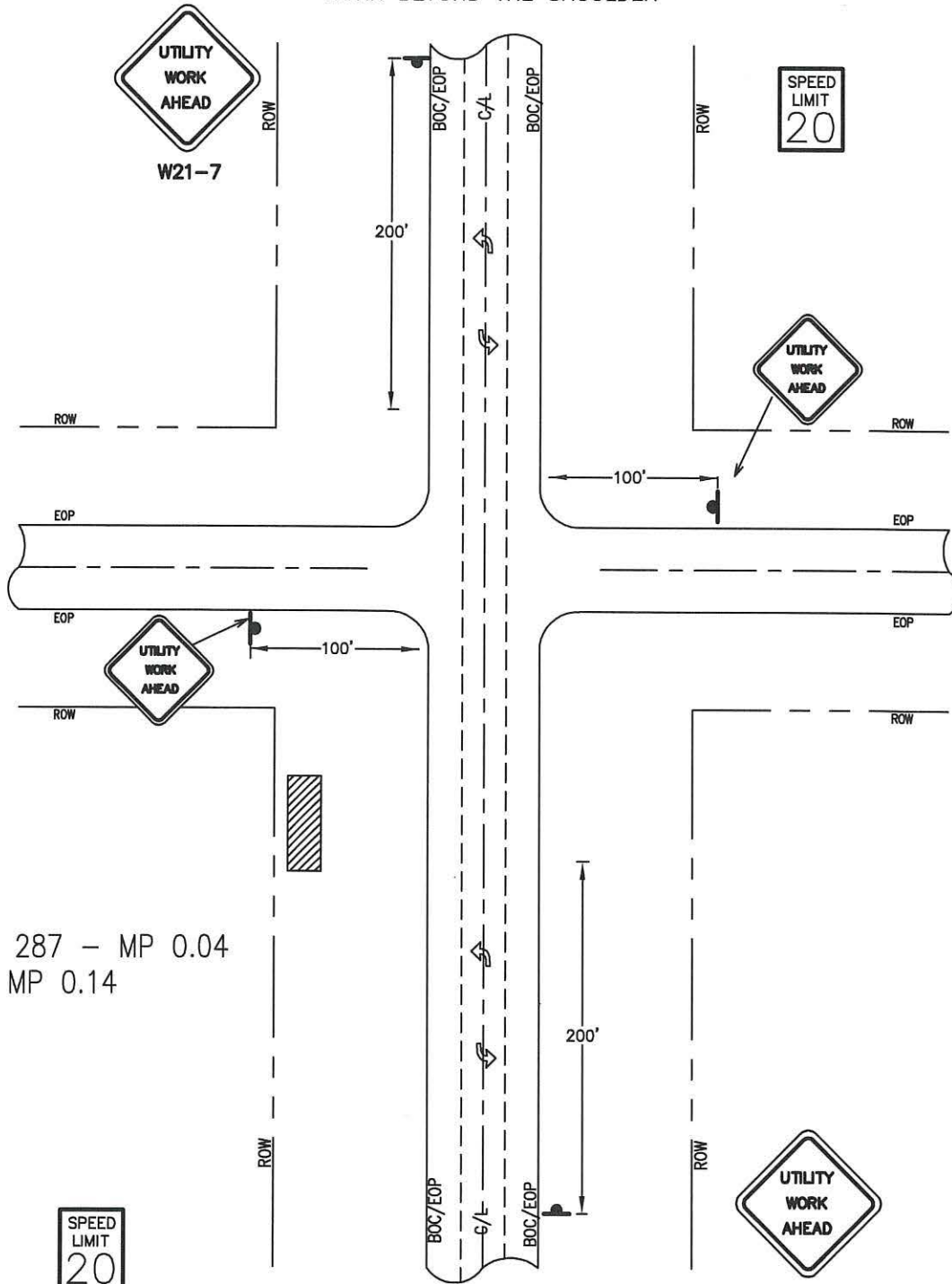

SR 287 - MP 0.04
to MP 0.14

SPEED
LIMIT
20



W21-7

Traffic control plan for work beyond the shoulder, Section 6H-1 & (TA-1) of the provisions of part VI of the manual on uniform traffic control devices.

ALL TRAFFIC CONTROL DEVICES SHALL CONFORM TO PART VI OF THE NATIONAL MANUAL OF UNIFORM TRAFFIC CONTROL DEVICES.

NO VEHICLES TO BE PARKED ON THE SHOULDER OF THE ROAD FACING ON-COMING TRAFFIC AT ANYTIME.

ROAD TYPE	A
URBAN (LOW SPEED)	200 FT
URBAN (HIGH SPEED)	350 FT
RURAL	500 FT

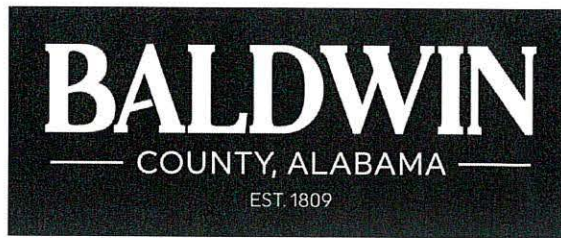

Best Management Practice

Baldwin County will place 96 count fiber optic cable inside (1) 1.5" HDPE conduit along Alabama Highway 287 (Hand Ave) in the City of Bay Minette, Baldwin County from MP 0.04 to MP 0.14, utilizing the buried method of placement. Every effort shall be made by every member of construction to minimize disturbance to the site and to traffic. The total surface area disturbed will be less than ¼ acre; therefore, a storm water permit is not required.

All operators of construction equipment shall be experienced and qualified on the equipment they are operating. All equipment shall be clean and in good operating condition free of any fluid leaks. No vehicles or equipment shall be serviced or refueled within 500 feet of any wetlands or streams.

The buried cable sections will utilize the directional bore method of placement. All vehicular traffic associated with this project shall be kept to a minimum and shall remain within the maintained portion of the right-of-way when possible. Personnel and vehicles shall be limited to one side of the road except during placement of crossings.

The total length of proposed buried fiber on DOT right-of-way will be 0.12 miles which will be placed by directional bore. The buried placement will maintain a minimum of 36" depth with 48" depth below paved side roads and driveways, 3' minimum vertical depth below all drain pipes and structures when crossing. Minimum of 24" separation from all other existing utilities and at crossing locations.

Due to the methods of construction selected for this project, minimal areas of construction requiring erosion control are anticipated. If necessary, erosion control procedures such as planting of grass seeds, sodding, covering the area with scattered hay, staked hay bales, and/or embedded and staked filter cloth will be implemented. These procedures will conform to guidelines as set forth in the Alabama Department of Transportation Standard Specifications for Highway Construction (Current Edition) Section 692 Seeding and Section 860 Roadside Improvement Material.

UTILITY PERMIT CHECKLIST

REV. FEBRUARY 2020

SW Region-Mobile Area

Applicant Baldwin County Route SR 287 Milepost 0.04-0.14

- ❖ Utility Companies use this checklist with the following Permit Applications: MB-01, MB-02, and MB-03.
- ❖ ALDOT Manuals are available online at: www.dot.state.al.us/maweb/permits_operations.html
- ❖ All submittals & questions should be directed to the District Office unless otherwise noted.
- ❖ All checklist items apply to most utility proposals, supply all information as listed within the permit materials. This list may not be all inclusive; ALDOT reserves the right to request additional information that may be needed for any proposal.
- ❖ Preliminary Discussions should be held with ALDOT for large scale Utility Projects or those that require extensive excavation/trenching or major traffic disruption.
- ❖ As-Built Certification & Addendum Request Process – After completion of work, the Engineer of Record (EOR) shall submit a signed certification letter stating the project has been constructed in accordance with the ALDOT approved plans, and with standards/ specifications applicable at the time of approval. Once a permit is approved, the design shall not be altered for any reason without gaining prior approval in writing from ALDOT through an official Permit Addendum request. Addendum requests can normally be handled within a few days if adequate information is provided. Changes resulting from a local municipal comment or directive does not approve the work, negate the ALDOT approved plan, nor does it override the Addendum process. It is the responsibility of the EOR to ensure their client is aware that only the ALDOT approved work shall be accepted.
- ❖ The District Office is to be notified 48 hours prior to beginning work on ROW. No lane closures are to be implemented without prior ALDOT approval and notification to ensure there are no conflicts.

District 1 (Mobile)

Mr. David A. Hollowell
District Administrator
1701 I-65 West Service Road North
Mobile, Alabama 36618
(251) 470-8219

District 2 (Baldwin)

Mr. David M. Styron II, P.E.
District Administrator
47450 Rabun Road
Bay Minette, Alabama 36507
(251) 937-2086

District 3 (Escambia/ Conecuh)

Mr. Mickey T. Jones
District Administrator
10610 Highway 31 South
Evergreen, Alabama, 36401
(251) 578-7546

MB-01: For use by a Public Utility Company, or more specifically defined as a utility which is regulated by the Public Service Commission (PSC) & can provide a PSC certification if requested.

MB-02 & MB-03: These are used for private utility companies or when a developer is responsible for utility related work on ALDOT ROW. Developers must provide a Letter of Concurrence from the utility owner.

Permit Submittal – 4 copies of each

- Permit application: Application and Bond must be in the name of the Legal Applicant (Utility Owner)
- Utility Permit Checklist
- Construction Plans, proposed bores under roadway must be stamped by Alabama Licensed PE
- ADEM Notice of Registration (If over 1 acre soil disturbance)
- Performance bond BM-174 (Amount Approved by ALDOT) (** 9.1 Permit Manual)
- OR Blanket Bond Continuation Letter/Certificate (If applicable)
- OR Cashier's check and Form W-9 (cashier's check, certified check)
- PDF of plans (can be emailed if under 22MB)

Permit Application (filled by Applicant): (1.4.1 Permit Manual)

- ❖ Permit Number & Associated Permits will be assigned by the District office
- Name of County
- Route Number (US-xx, SR-xx, I-xx) and Mile Post to the nearest 0.01 mile
- Date of submitted application, include bond amount, bond number

UTILITY PERMIT CHECKLIST

REV. FEBRUARY 2020

SW Region-Mobile Area

Applicant's Legal Name & signature, mailing address, phone number, and witness signature

General Permit Plan Requirements: (specific permit requirements follow)

Vicinity Map (State & US routes labeled clearly, state name/ direction of nearest town)

North arrow; Scale or "Not to Scale"; Mile Post (nearest 0.01 mile beginning to end)

Route Number (SR-xx, US-xx, I-xx) and Posted Speed limits within boundaries of permit

Detailed Legend Required

Denote Centerline (CL), Rights-of-Way (ROW), Edge of Pavement (EOP) and Property Lines

Distances: Centerline to ROW line, EOP to ROW line, proposed work to ROW line

Distances: EOP to flow line of side ditches, roadway widths, lane widths

Include details applicable to permit type

All applicable ALDOT Standard and Special Drawings must be included in plans

Erosion control plan (BMP) is needed if an ADEM permit was not required for project

Traffic Control Plan - (utilizing all guidelines of the 2009 MUTCD, site specific)

ALDOT Permit General Notes must be included in the plan set (see pages 4-6)

Show all existing & proposed utilities, appurtenances, drainage structures/ pipes & accessories and provide the distance from the ROW line.

- Existing utilities shall be represented both horizontally and vertically in the submitted plans. Notes shall not insinuate or imply "Approximate" locations as they are not accepted.
- If deemed necessary by ALDOT, existing utilities shall be presented in the field by means of flagging, staking, painting, and potholing/ probing for inspection by ALDOT Representatives.
- Vertical location of utility lines is to be accurately reflected in cross section views.
- It should be determined prior to construction if minimum coverage of utilities will be maintained upon completion of work. Aerial only installation does not require location of underground facilities.
- If no existing utilities are present, state "No Existing Utilities"

Utility Permit Plan Specific Requirements: (MB-01, MB-02, MB-03) (4.2 Utility Manual)

Utilities must be placed 25' min horizontally from nearest bridge support (columns, abutments, etc.) and 12' min horizontally from culvert headwalls, wing walls, and foundations.

All type roadway crossings shall be as near perpendicular as possible to the roadway

Underground Utilities

Underground utilities installed across Interstate ROW must be bored not open cut

Roadway crossings- Plan View

- Type to be used (Ex. - Dry Bore)
- Show milepost for each proposed bore
- Show encasements if required, any other utilities or drainage structures, etc.
- Crossing should be as perpendicular to the road as possible

Show abandoned utility lines

- Abandoned lines 4" or greater shall be filled with grout or removed.

If a patch is to be made, the repair limits and buildup must be approved and shown in the plans

Depth of Bury (additional depth may be required)

- 36" min. beneath the flow line of ditch, 48" min. under pavement, 8' min. beneath flow line of stream

Bore Method & Bore Design Letter signed by Engineer of Record

- Type of Bore with procedure and specifications, boring head, reamer size & fluid type
- Directional bores shall include bore design information signed by the engineer of record. (Include: fluid type & normal operating PSI and GPM (the maximum allowable fluid rate is 350 PSI at 15 GPM))
- Letter to include note: The max allowable ratio will not be exceeded without prior ALDOT approval.

Bores that require bore pits must state/depict bore pit dimensions (length x width x depth)

- Bore pits must be located outside D/A fence on interstate crossings
- Side roads must be bored & encased if ADT > 500

UTILITY PERMIT CHECKLIST

REV. FEBRUARY 2020

SW Region-Mobile Area

- plowing or trenching will not be allowed within the road prism area
- Profile of proposed Bore Crossings (label R/W, pipe, ground, etc)
- Profile if manholes are permitted (Manholes must be flush with existing ground line)
- All meters shall be installed off ALDOT rights-of-way
- Horizontal distance from bridge footings or drainage structures is 25 foot minimum
- Type marking to be placed with underground power lines and/ or non-metallic conduit (Metallic tape, flagging, etc.)

Encasements for Roadway Crossings

- Water and Sewer mains larger than 2" shall be encased, materials may vary
- Gas mains larger than 2" shall be encased in coated steel
- Communication lines may use continuous roll HDPE
- Minimum depth measurement is measured from the base of pavement to top of encasement
- Encasement size, length (min.: back of ditch to back of ditch), type of material and coating
- Encasements beneath Interstates should extend beyond the denied access on both sides
- An individual steel or copper service line of 2" or smaller may cross under the roadway without encasement. A copper line must be Type "K", continuous roll and be labeled on the plans to cross under the road without encasement. Municipex Type A is equiv. to Copper Type K (2" or less, continuous roll).
- Encasement variance for a utility line along/across the highway will only be accepted if the API accompanied by a Pisces or Technical Toolbox computer generated report. The report shall adhere to 1102 and the PRCI Report PR-227-9424.
- Spacer Detail (wooden spacers are not permitted for use in ROW)

Aerial Utilities:

- Profile of Roadway Crossing, showing pole height, vertical clearances over centerline of travel ways, arm length if street light
 - Minimum of 18' of clearance over travel ways
 - Maintain a vertical and horizontal clearance of 25' over bridges
 - Vertical - from the top of the barrier rail
 - Horizontal - from the neat lines of the structure
 - Clearance shown should be height of cable over travel lanes and sag point in line
- Guy Wire requirements (Utility Manual 2.18.3)
- Small cell sites must be specifically permitted as such, no new poles in ROW are allowed, all aspects of operational need must be presented in plan set.
- Poles shall be placed outside clear zone or and outside denied access fence on Interstate routes.
- Proposed poles to be replaced/installed to an existing line shall be "In-Line"
- Installation of new poles and/ or pole foundations require the location of existing underground utility lines and any drainage structures present to be shown in the plans.

Interstate Crossing: (In addition to utility plan requirements)

- Installation procedure including Traffic Control Plan
 - Law enforcement who have authority on Interstate within the project area will be on hand for traffic control and their location should be included on the diagram.
 - Diagram showing the location of work trucks, if needed inside the ROW.
 - If work trucks are needed inside of the D/A fence, their location should be included on the diagram.
 - If stoppage of traffic is required, the day of week, time of day, and duration of stoppage should be included. Effort should be made to limit the time of lane closure. (Max. time is 10 minutes/stop or block)
 - Traffic control plan must meet most current edition of MUTCD. **Note regarding the rolling stop of traffic on the interstate, if a rolling stop is necessary an estimated time is required. (Maximum of 10 minutes for interstate closures)

UTILITY PERMIT CHECKLIST

REV. FEBRUARY 2020

SW Region-Mobile Area

Permit General Notes:

Notes:

1. All informational blanks within the notes are required to be completed.
 2. Applicant is used to describe the legal permit applicant or any of their representatives, contractors, or assigns.
1. All meters shall be installed off of ALDOT Right-of-Way.
 2. All manholes, valve boxes, and hand holes should be flush with existing ground.
 3. Applicant shall contact the District Administrator 48 hours prior to beginning work on ALDOT Right-of-Way. The District Administrators are as follows:
Area- 9
(91) Mobile County – David A. Hollowell, (251) 470-8219
(92) Baldwin County – David M. Styron II, P.E. (251) 937-2086
(93) Escambia and Conecuh Counties – Mickey T. Jones, (251) 578-7540
 4. The Engineer of Record shall promptly write an As-Built Certification letter to the District Administrator requesting an inspection upon completion of the permitted work. Any punch list items shall be completed prior to Provisional Acceptance of work.
 5. Bonds submitted for permits shall be held for a (1) one-year Maintenance Period which begins on the Provisional Acceptance date issued by the Department. During this time any failures, deficiencies, or maintenance care shall be the responsibility of the applicant. At the end of the Maintenance Period the applicant or Engineer of Record shall submit a bond release request letter to the District Administrator, bonds are not released without request.
 6. All traffic control shall be in accordance with Part 6 of the Manual on Uniform Traffic Control Devices (MUTCD) 2009 edition. (If project necessitates lane closure, lane closure must be made part of the permit.)
 7. Onsite Representatives & Contact Information MARK SAXON 870-866-2081 B&L Cable Construction
 8. Onsite representatives will have on hand, at all times:
 - (1) Approved permit and plans stamped by the Region Engineer
 - (2) Traffic Control Plans
 - (3) Erosion Control Plans
 9. All disturbed areas on ROW shall receive 4" of topsoil and be sodded or seeded as directed by the Department.
 10. All work on the ROW will be in conformance with the latest edition of ALDOT Standard Specifications.
 11. Electric power and communication facilities will conform to the current applicable *National Electrical Safety Code*.
 12. A Best Management Plan shall at minimum return all exposed areas to original or better condition and require stand of grass and/or sod before acceptance. Silt fence and any other erosion control items needed shall be used to prevent erosion. (NO HAYBALES ARE ALLOWED IN ROW)
 13. All trees over 4" DBH shall not be cut/removed without written permission from ALDOT.
 14. Absolutely no bore pits shall be allowed to be unfilled and/or uncovered overnight unless protected. (Bore pits have a maximum of 72 hours to be open before filled.)
 15. Upon completion & any time thereafter, ALDOT retains the right to request an As-Built plan of any permitted work in said department's Rights-of-Way (ROW).
 16. WARNING: Do not disturb Survey Markers located on ALDOT Right-of-Way. Any property markers disturbed during construction shall be re-established by an Alabama licensed professional land surveyor at the expense of the permit applicant.
 17. The total area to be disturbed during construction of this permit: .25 acre(s). (On & Off ROW combined)
 18. Water lines shall conform to the currently applicable standards of the *American Water Works Association*.
 19. Pressure pipe lines shall conform to the currently applicable sections of *American National Standards Institute (ANSI)*.
 20. As required by Alabama Act 94-487: Call two working days before excavation 1-800-292-8525, Alabama Line Location Center, Inc.

UTILITY PERMIT CHECKLIST

REV. FEBRUARY 2020

SW Region-Mobile Area

21. All existing utility facilities in the proposed work area shall be physically located both horizontally and vertically.
 - a. The utility facilities in the area of work are represented to the best of my knowledge, according to locates provided by 811 and individual due diligence. Engineer Initials JDT
 - b. 811 Locate Request # 203510997 & 203571429
22. Any ornamental vegetative landscaping (shrubs, flowers, ornamental grass, etc.) disturbed during construction shall be replaced, transplanted or sodded by the applicant as directed by the Alabama Department of Transportation District Administrator.
23. All fill material or onsite debris deposited in the right-of-way shall be removed prior to issuance of final acceptance to begin the one-year maintenance period of the permit contract.
24. The applicant shall see that all solid waste (I.E., wood, stumps, etc.) is disposed of in accordance with applicable regulations of the Alabama Department of Environmental Management (ADEM).
25. Property obstructions which are to remain in place, such as historical structures, trees, drains, water or gas pipes, poles, wall, etc., are not to be disturbed unless noted and approved by SHPO, ALDOT, ADEM, EPA, etc.
26. The applicant is responsible to see that streets are cleaned immediately after concrete or other delivery trucks leave the site. Mud and debris are to be kept off streets, and out of inlets, ditches, etc.
27. Fuel tanks shall not be stored on the right-of-way overnight. Vehicles transporting fuel, chemicals, fertilizers, etc. onto right-of-way shall not be left unattended.
28. The applicant or Engineer of Record shall promptly notify ALDOT of any perceived conflicts, ambiguous items or deficiencies in the plans, specifications, general notes or related contract documents.
29. For work within Interstate ROW, all ingress and egress to worksite shall be from applicant's property. No access shall be gained from the Interstate ROW. Equipment and materials shall not be stored on Interstate ROW.
30. Milepost(s) 0.04 to 0.14 Speed Limit 20 Stopping Site Distance 200'
31. Is drainage/ runoff from this site directed onto state ROW? (circle) **YES** or **NO** Engineer Initials JDT
32. Are utility, signal or light pole, related conflicts present or are any relocations required for this project to be constructed as proposed in these plans? (circle) **YES** or **NO** Engineer Initials JDT
33. Minimum cover over utilities shall be maintained upon completion of work.
(circle) **YES** or **NO** Engineer Initials JDT
34. The legal permit applicant is held responsible and liable for all damages, actions, or responsibilities of their appointed contractors, assigns, or appointees.

Baldwin County

APPLICANT NAME

251-580-2598

APPLICANT PHONE #

Baldwin County

105 W. Third Street

Bay Minette, AL 36507

APPLICANT MAILING ADDRESS

Baldwin County - CIS

105 W. Third Street

Bay Minette, AL 36507

MAILING ADDRESS FOR
APPROVED PERMIT

February 2, 2021

DATE

John D. Thomas-PROLINE DESIGN,LLC

ENGINEER OF RECORD

334-467-0243

ENGINEER'S PHONE NUMBER

johnthomas@pro-linedesign.com

ENGINEER'S EMAIL ADDRESS

JOB VICINITY MAP

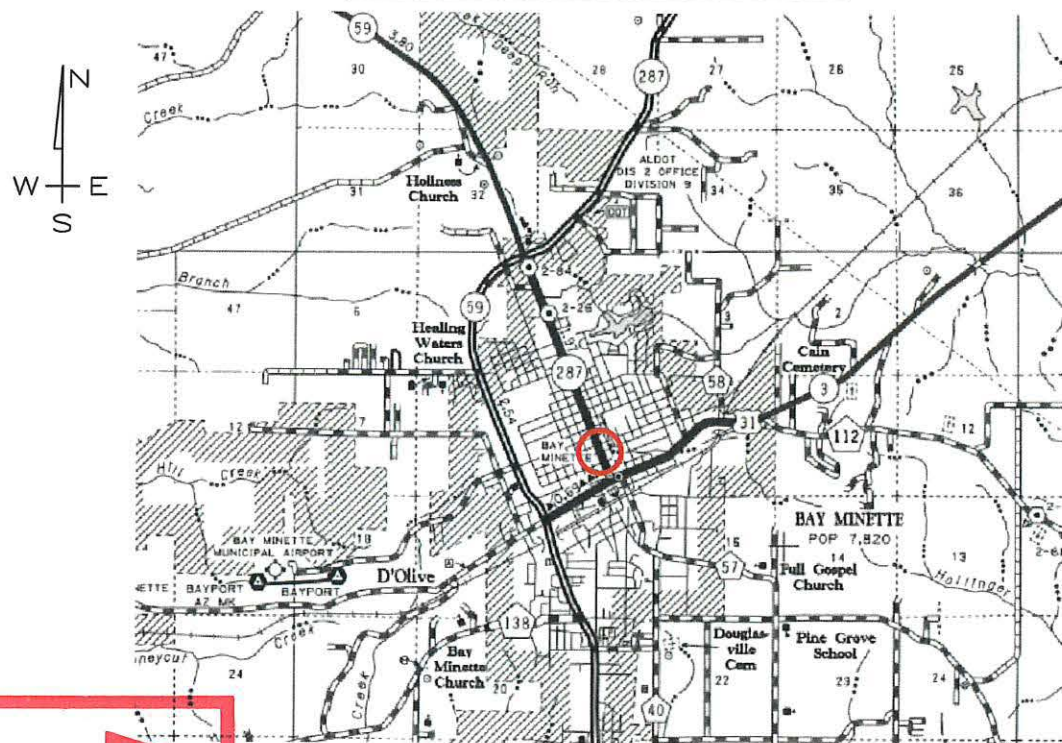

JOB LOCATION MAP



Permit General Notes:

1. MAKE THIS A SAFE JOB.
2. All manholes, valve boxes, and hand holes should be flush with existing ground.
3. Applicant shall contact the District Administrator 48 hours prior to beginning work on ALDOT Right-of-Way. The District Administrators are:
DISTRICT 92 PERMIT MANAGER, MR. DARRIN REED AT 251-937-2086.
(92) Baldwin County -David M. Styron II, P.E. (251) 937-2086
4. The Engineer of Record shall promptly write an As-Built Certification letter to the District Administrator requesting an inspection upon completion of the permitted work. Any punch list items shall be completed prior to Provisional Acceptance of work.
5. Bonds submitted for permits shall be held for a (1) one-year Maintenance Period which begins on the Provisional Acceptance date issued by the Department. During this time any failures, deficiencies, or maintenance care shall be the responsibility of the applicant. At the end of the Maintenance Period the applicant or Engineer of Record shall submit a bond release request letter to the District Administrator, bonds are not released without request.
6. All traffic control shall be in accordance with Part 6 of the Manual on Uniform Traffic Control Devices (MUTCD) 2009 edition. (If project necessitates lane closure, lane closure must be made part of the permit.)
7. Onsite Representatives & Contact Information: Mark Saxon 870-866-2081 (B&L Cable Construction)
8. Onsite representatives will have on hand, at all times:
 - (1) Approved permit and plans stamped by the Region Engineer
 - (2) Traffic Control Plans
 - (3) Erosion Control Plans
9. All disturbed areas on ROW shall receive 4" of topsoil and be sodded or seeded as directed by the Department.
10. All work on the ROW will be in conformance with the latest edition of ALDOT Standard Specifications.
11. Electric power and communication facilities will conform to the current applicable National Electrical Safety Code.
12. A Best Management Plan shall at minimum return all exposed areas to original or better condition and require stand of grass and/or sod before acceptance. Silt fence and any other erosion control items needed shall be used to prevent erosion. (NO HAYBALES ARE ALLOWED IN ROW)
13. All trees over 4" DBH shall not be cut/removed without written permission from ALDOT.
14. Absolutely no bore pits shall be allowed to be unfilled and/or uncovered overnight unless protected. (Bore pits have a maximum of 72 hours to be open before filled.)
15. Upon completion & any time thereafter, ALDOT retains the right to request an As-Built plan of any permitted work in said department's Rights-of-Way (ROW).
16. WARNING: Do not disturb Survey Markers located on ALDOT Right-of-Way. Any property markers disturbed during construction shall be re-established by an Alabama licensed professional land surveyor at the expense of the permit applicant.
17. The total area to be disturbed during construction of this permit: .25 acre(s). (On & Off ROW combined)
18. Water lines shall conform to the currently applicable standards of the American Water Works Association.
19. Pressure pipe lines shall conform to the currently applicable sections of American National Standards Institute (ANSI).
20. As required by Alabama Act 94-487: Call two working days before excavation 1-800-292-8525, Alabama Line Location Center, Inc.

APPROVED
BY ALDOT:
Mattie Sird

EXISTING UTILITIES LEGEND

- ⊗ JOINT USAGE POLE
- TELEPHONE POLE
- ⊗ TELEPHONE PED
- ⊕ WATER VALVE
- ⊕ WATER METER
- ⊕ FIRE HYDRANT

PROPOSED LEGEND

- MARKER
- BORE PATH
- HANDHOLE
- BORE PIT
- LD WORK LOCATION DESIGNATION

SYMBOL LEGEND

- STORM DRAIN
- DRAIN INLET
- CATCH BASIN
- CENTER LINE
- R.O.W. LINE
- X-X-X- FENCE LINE

PLD PRO-LINE DESIGN
 1020 MONTICELLO CT., SUITE 201
 MONTGOMERY, AL 36117
 334-467-0243

B&L
 CABLE CONSTRUCTION
 11446 Brooklyn Rd
 ANDALUSIA, AL 36421
 334-427-0888

DRAWN BY: PLD-MTT J2026
 DATE: 12-28-20
 DATE: (AS BUILT)

MAP # 1 OF 4

SCALE:

BALDWIN COUNTY
 PROPOSED INSTALLATION OF FIBER OPTIC CABLE
 Alabama 287-Hand Ave (Bay Minette, AL)

CROSS-SECTION VIEW

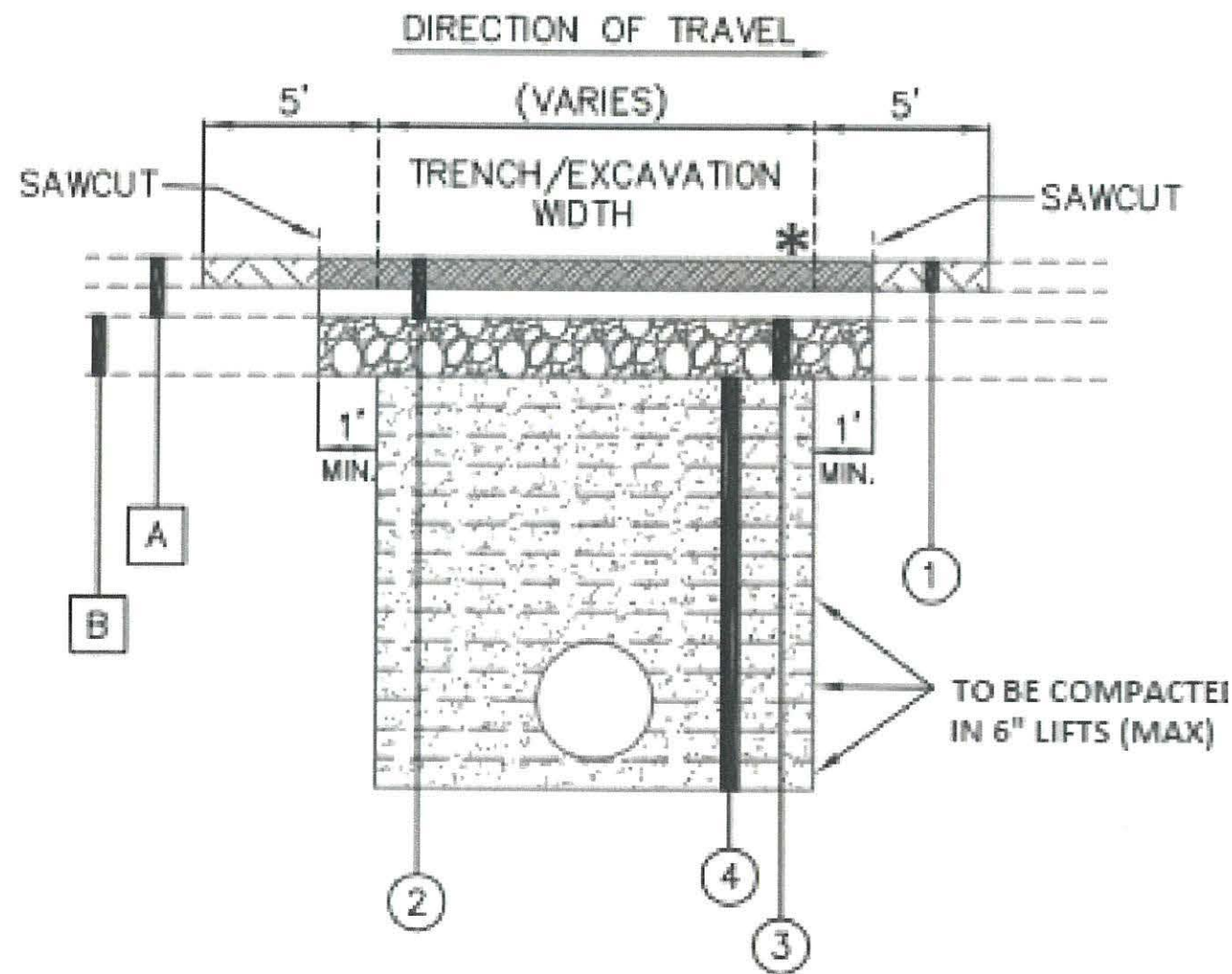

EXISTING MATERIALS LEGEND

- A. EXISTING INPLACE PAVEMENT
- B. EXISTING INPLACE ROADWAY BASE

REQUIRED MATERIALS LEGEND

- 1. ALDOT 429A IMPROVED BITUMINOUS CONCRETE WEARING SURFACE LAYER (MATCH EXISTING THICKNESS)
- 2. ALDOT 429B IMPROVED BITUMINOUS CONCRETE BINDER LAYER (MATCH EXISTING THICKNESS)
- 3. ALDOT 301A CRUSHED AGGREGATE BASE COURSE, TYPE B, PLANT MIXED, 6" COMPACTED THICKNESS (COMPACTED TO 100% MAX DRY DENSITY)
- 4. ALDOT 210D BORROW EXCAVATION (A2 OR BETTER) (COMPACTED TO 95% MAX DRY DENSITY) (PLACED IN 6" MAX LIFTS)[†]
[†] ALDOT 210F BORROW EXCAVATION (UNDERWATER BACKFILL) (ALDOT #57 STONE) MAY BE USED ONLY WHEN PROPER COMPACTION CANNOT BE ACHIEVED DUE TO EXCAVATION BELOW THE WATERTABLE OR OBSTRUCTIONS SUCH AS UTILITIES.

EXISTING UTILITIES LEGEND

- ⊗ JOINT USAGE POLE
- TELEPHONE POLE
- ⊠ TELEPHONE PED
- ⊕ WATER VALVE
- ⊙ WATER METER
- ⊖ FIRE HYDRANT

PROPOSED LEGEND

- MARKER FIBER CABLE MARKER
- BORE PATH
- HANDHOLE
- BORE PIT
- LD WORK LOCATION DESIGNATION

SYMBOL LEGEND

- STORM DRAIN
- ⊠ DRAIN INLET
- ⊠ CATCH BASIN
- CENTER LINE
- R.O.W. LINE
- x-x-x- FENCE LINE

PLD PRO-LINE DESIGN
 1020 MONTICELLO CT., SUITE 201
 MONTGOMERY, AL 36117
 334-467-0243

B&L
 CABLE CONSTRUCTION
 11446 Brooklyn Rd
 ANDALUSIA, AL 36421
 334-427-0888

DRAWN BY: PLD-MTT J2026
 DATE: 12-28-20
 DATE: (AS BUILT)

MAP # 1A OF 4
 SCALE: NTS

BALDWIN COUNTY
 PROPOSED INSTALLATION OF FIBER OPTIC CABLE
 Alabama 287-Hand Ave (Bay Minette, AL)

CAUTION: EXISTING UTILITIES IN AREA. CONTRACTOR MUST CONTACT ALABAMA 811 ONE-CALL & LOCATE ALL EXISTING UTILITIES PRIOR TO CONSTRUCTION.

SPEED LIMIT
20

EXISTING UTILITY LINE LEGEND

WATER	W	SEWER	S
GAS	G	TELEPHONE	T
TELEPHONE	T	SEWER	S
SEWER	S	TELEPHONE	T

1.5" HDPE DUCT
(96 COUNT FIBER)

LD
2.3

DIRECTIONAL BORE AND PLACE 1.5" HDPE

48" Min. Depth Under Pavement

MP 0.04
BORE PIT,
4'x 4'x 4'
CUT & RESTORE ASPHALT

SEE DETAIL MAP SHEET 1A

BEGIN PERMIT
MP 0.04
ENTER EXISTING HANDHOLE

PLACE 100' COIL 96 COUNT FOC

SEE GENERAL NOTES ON SHEET 1 FOR PROJECT NOTES AND SPECIFICATIONS PRIOR TO STARTING ANY CONSTRUCTION.

BALDWIN COUNTY EXISTING HANDHOLE AND FIBER OPTIC CABLE

UNIDENTIFIED HANDHOLE & FOC NOT LOCATED AT TIME OF SURVEY

EXISTING UTILITIES LEGEND

- ⊗ JOINT USAGE POLE
- TELEPHONE POLE
- ⊕ TELEPHONE PED
- ⊕ WATER VALVE
- ⊕ WATER METER
- ⊕ FIRE HYDRANT

PROPOSED LEGEND

- MARKER FIBER CABLE MARKER
- BORE PATH
- HANDHOLE
- BORE PIT
- LD WORK LOCATION DESIGNATION

SYMBOL LEGEND

- STORM DRAIN
- ⊕ DRAIN INLET
- ⊕ CATCH BASIN
- CENTER LINE
- R.O.W. LINE
- x-x-x- FENCE LINE

PLD PRO-LINE DESIGN
1020 MONTICELLO CT., SUITE 201
MONTGOMERY, AL 36117
334-467-0243

B&L CABLE CONSTRUCTION
11446 Brooklyn Rd
ANDALUSIA, AL 36421
334-427-0888

DRAWN BY: PLD-MTT J2026
DATE: 12-28-20
DATE: (AS BUILT)

MAP # 2 OF 4
SCALE: 1"=20'

BALDWIN COUNTY
PROPOSED INSTALLATION OF FIBER OPTIC CABLE
Alabama 287-Hand Ave (Bay Minette, AL)

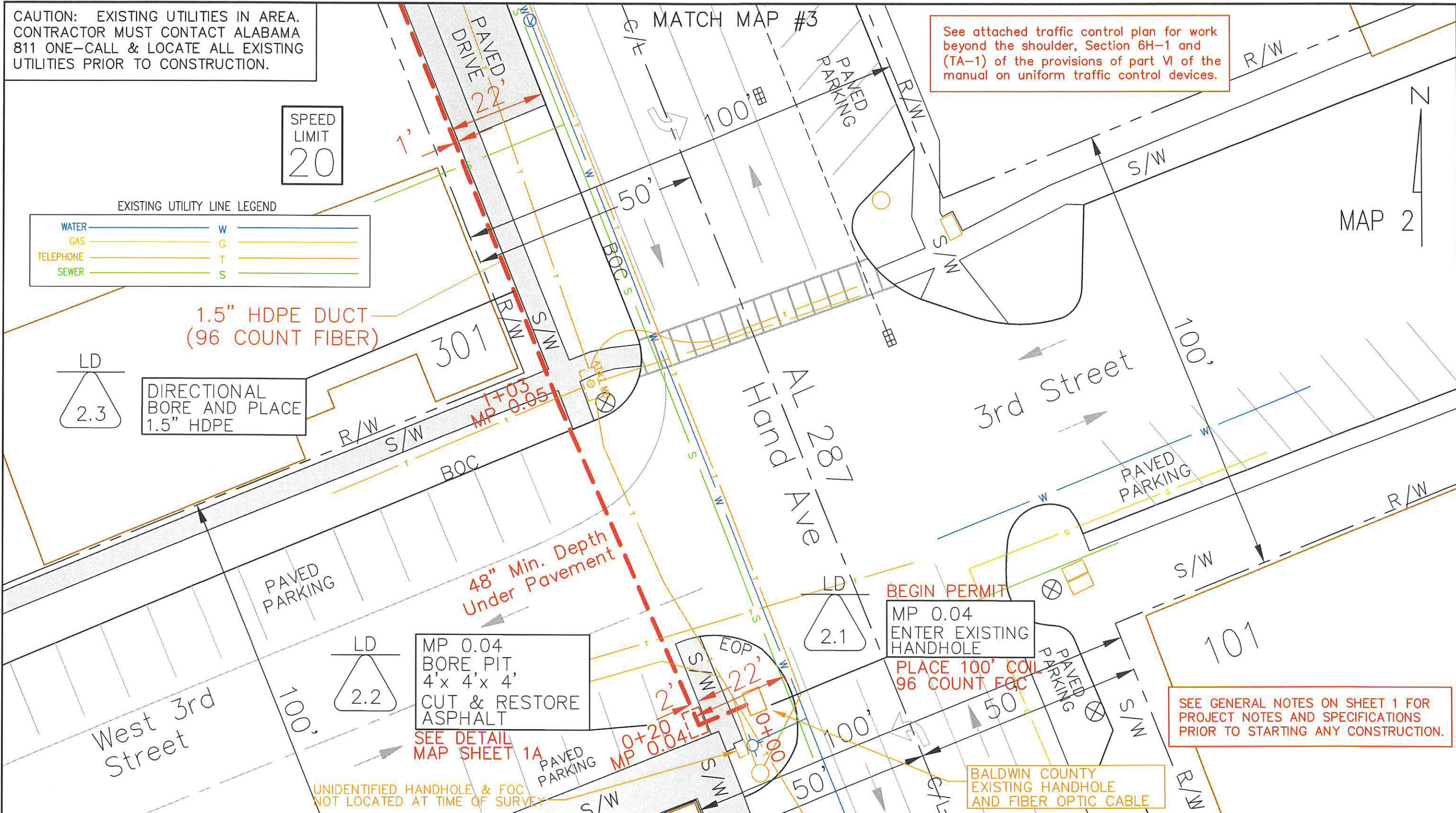

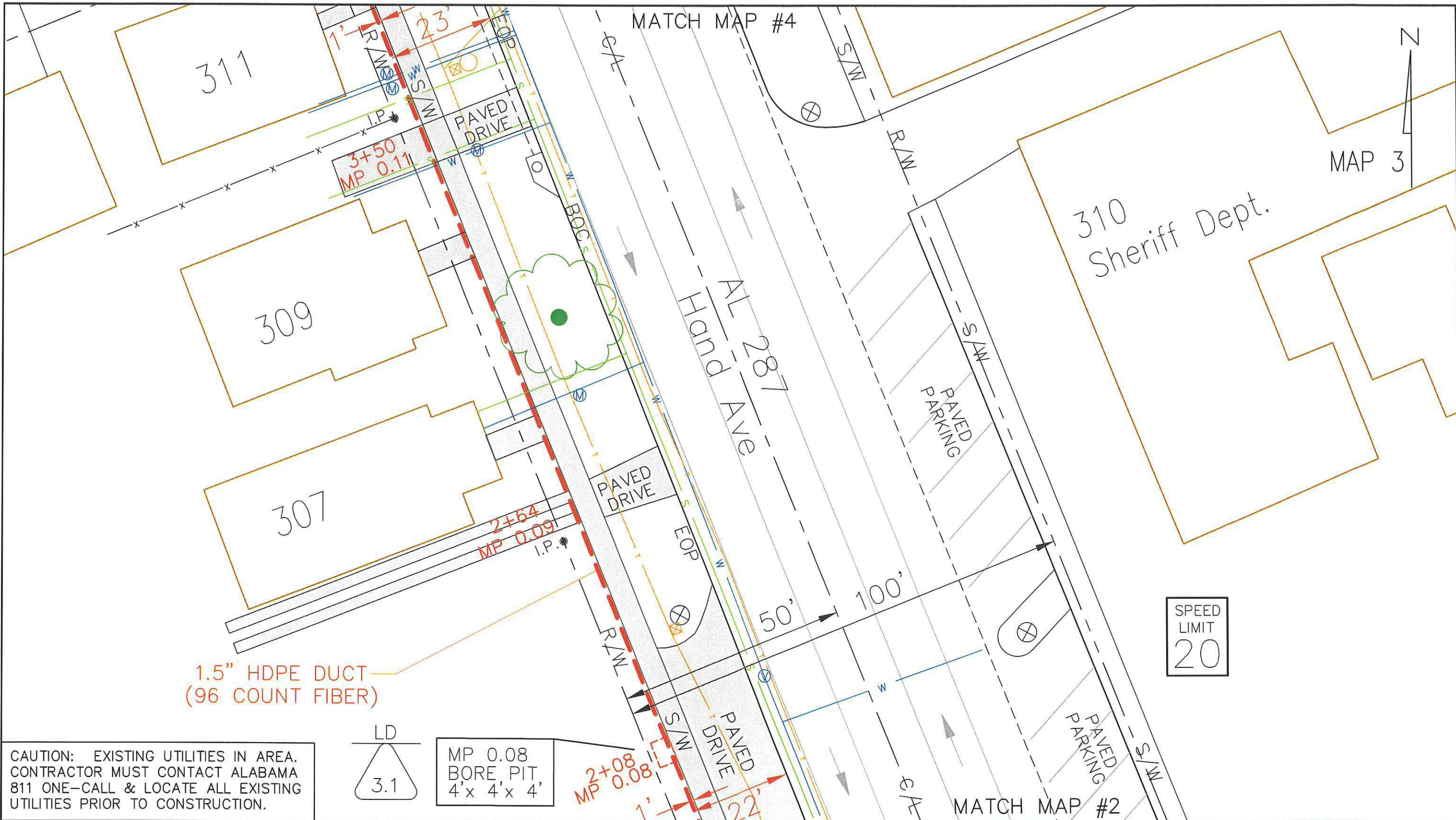

CAUTION: EXISTING UTILITIES IN AREA. CONTRACTOR MUST CONTACT ALABAMA 811 ONE-CALL & LOCATE ALL EXISTING UTILITIES PRIOR TO CONSTRUCTION.

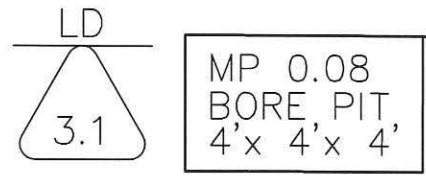

EXISTING UTILITIES LEGEND

- ⊗ JOINT USAGE POLE
- TELEPHONE POLE
- ⊗ TELEPHONE PED
- ⊕ WATER VALVE
- ⊕ WATER METER
- ⊕ FIRE HYDRANT

PROPOSED LEGEND

- MARKER FIBER CABLE MARKER
- BORE PATH
- HANDHOLE
- BORE PIT
- LD WORK LOCATION DESIGNATION

SYMBOL LEGEND

- STORM DRAIN
- ⊕ DRAIN INLET
- ⊕ CATCH BASIN
- CENTER LINE
- R.O.W. LINE
- x-x-x- FENCE LINE

PLD PRO-LINE DESIGN
 1020 MONTICELLO CT., SUITE 201
 MONTGOMERY, AL 36117
 334-467-0243

B&L
 CABLE CONSTRUCTION
 11446 Brooklyn Rd
 ANDALUSIA, AL 36421
 334-427-0888

DRAWN BY: PLD-MTT J2026
 DATE: 12-28-20
 DATE: (AS BUILT)

MAP # 3 OF 4
 SCALE: 1"=20'

BALDWIN COUNTY
 PROPOSED INSTALLATION OF FIBER OPTIC CABLE
 Alabama 287-Hand Ave (Bay Minette, AL)

SPEED LIMIT
 20

CAUTION:
CONTRACTOR MUST VERIFY DEPTH ON ALL EXISTING UTILITIES AND DRAINAGE STRUCTURES PRIOR TO CROSSING.

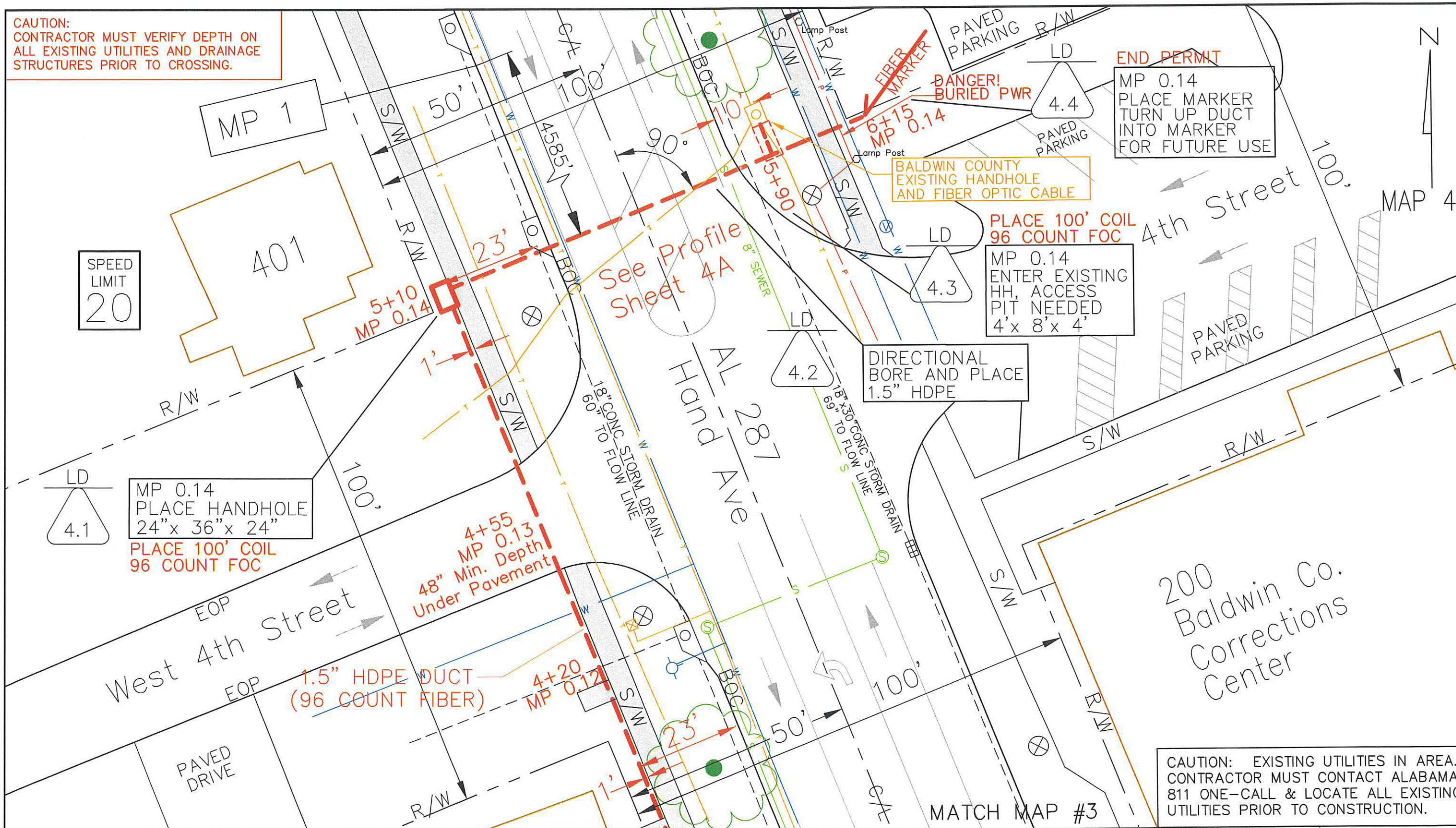

EXISTING UTILITIES LEGEND

⊗	JOINT USAGE POLE
○	TELEPHONE POLE
⊗	TELEPHONE PED
⊕	WATER VALVE
⊕	WATER METER
⊕	FIRE HYDRANT

PROPOSED LEGEND

—	MARKER	FIBER CABLE MARKER
—	BORE PATH	BORE PATH
□	HANDHOLE	HANDHOLE
□	BORE PIT	BORE PIT
LD	WORK LOCATION DESIGNATION	WORK LOCATION DESIGNATION

SYMBOL LEGEND

---	STORM DRAIN
---	DRAIN INLET
⊕	CATCH BASIN
---	CENTER LINE
---	R.O.W. LINE
-x-x-x-	FENCE LINE

PRO-LINE DESIGN
1020 MONTICELLO CT., SUITE 201
MONTGOMERY, AL 36117
334-467-0243

B&L
CABLE CONSTRUCTION
11446 Brooklyn Rd
ANDALUSIA, AL 36421
334-427-0888

DRAWN BY: PLD-MTT J2026
DATE: 12-28-20
DATE: (AS BUILT)

MAP # 4 OF 4
SCALE: 1"=20'

BALDWIN COUNTY
PROPOSED INSTALLATION OF FIBER OPTIC CABLE
Alabama 287-Hand Ave (Bay Minette, AL)

CAUTION: EXISTING UTILITIES IN AREA. CONTRACTOR MUST CONTACT ALABAMA 811 ONE-CALL & LOCATE ALL EXISTING UTILITIES PRIOR TO CONSTRUCTION.

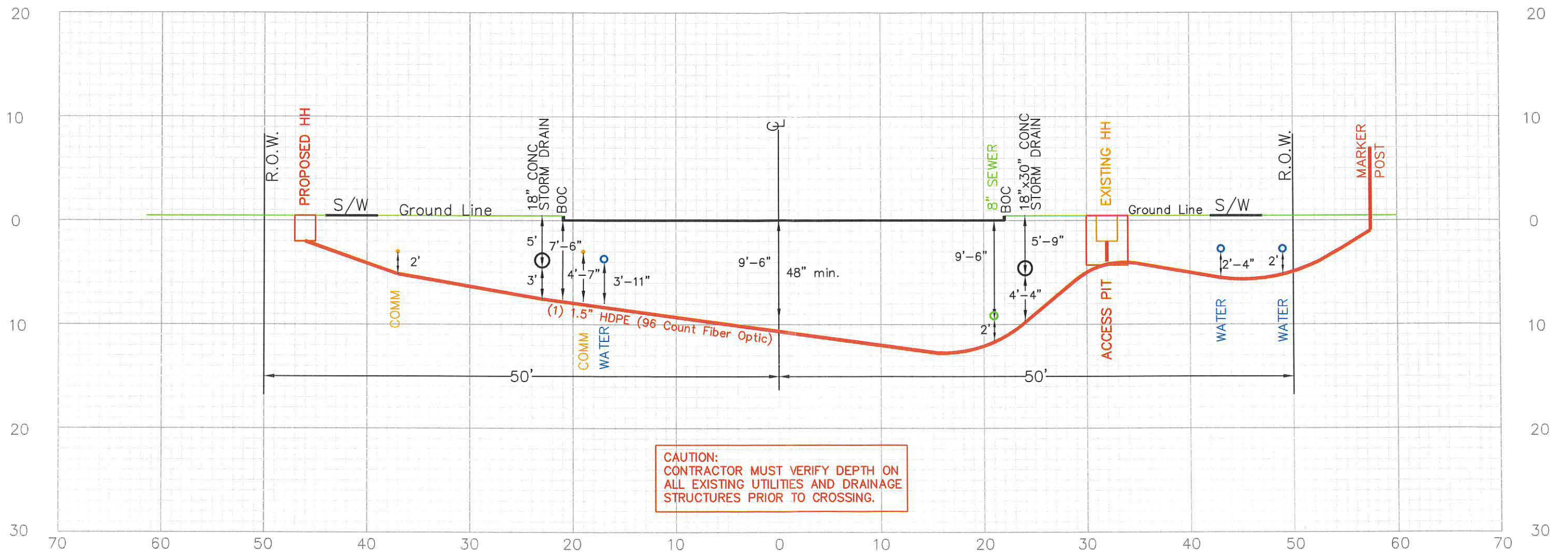

CAUTION:
CONTRACTOR MUST VERIFY DEPTH ON
ALL EXISTING UTILITIES AND DRAINAGE
STRUCTURES PRIOR TO CROSSING.

PROFILE
CROSSING
AL HWY 287 – Hand Ave
MP 0.14
LOOKING NORTH

EXISTING UTILITIES LEGEND

- ⊗ JOINT USAGE POLE
- TELEPHONE POLE
- ⊠ TELEPHONE PED.
- ⊕ WATER VALVE
- ⊙ WATER METER
- ⊕ FIRE HYDRANT

PROPOSED LEGEND

- MARKER FIBER CABLE MARKER
- BORE PATH
- HANDHOLE
- BORE PIT
- LD WORK LOCATION DESIGNATION

SYMBOL LEGEND

- STORM DRAIN
- ⊠ DRAIN INLET
- ⊕ CATCH BASIN
- CENTER LINE
- R.O.W. LINE
- x-x-x- FENCE LINE

PLD PRO-LINE DESIGN
1020 MONTICELLO CT., SUITE 201
MONTGOMERY, AL 36117
334-467-0243

B&L
CABLE CONSTRUCTION
11446 Brooklyn Rd
ANDALUSIA, AL 36421
334-427-0888

DRAWN BY: PLD-MTT J2026
DATE: 12-28-20
DATE: (AS BUILT)

MAP # 4A OF 4
SCALE: BY GRID

BALDWIN COUNTY
PROPOSED INSTALLATION OF FIBER OPTIC CABLE
Alabama 287-Hand Ave (Bay Minette, AL)

REFERENCE PROJECT NO.	FISCAL YEAR	SHEET NO.

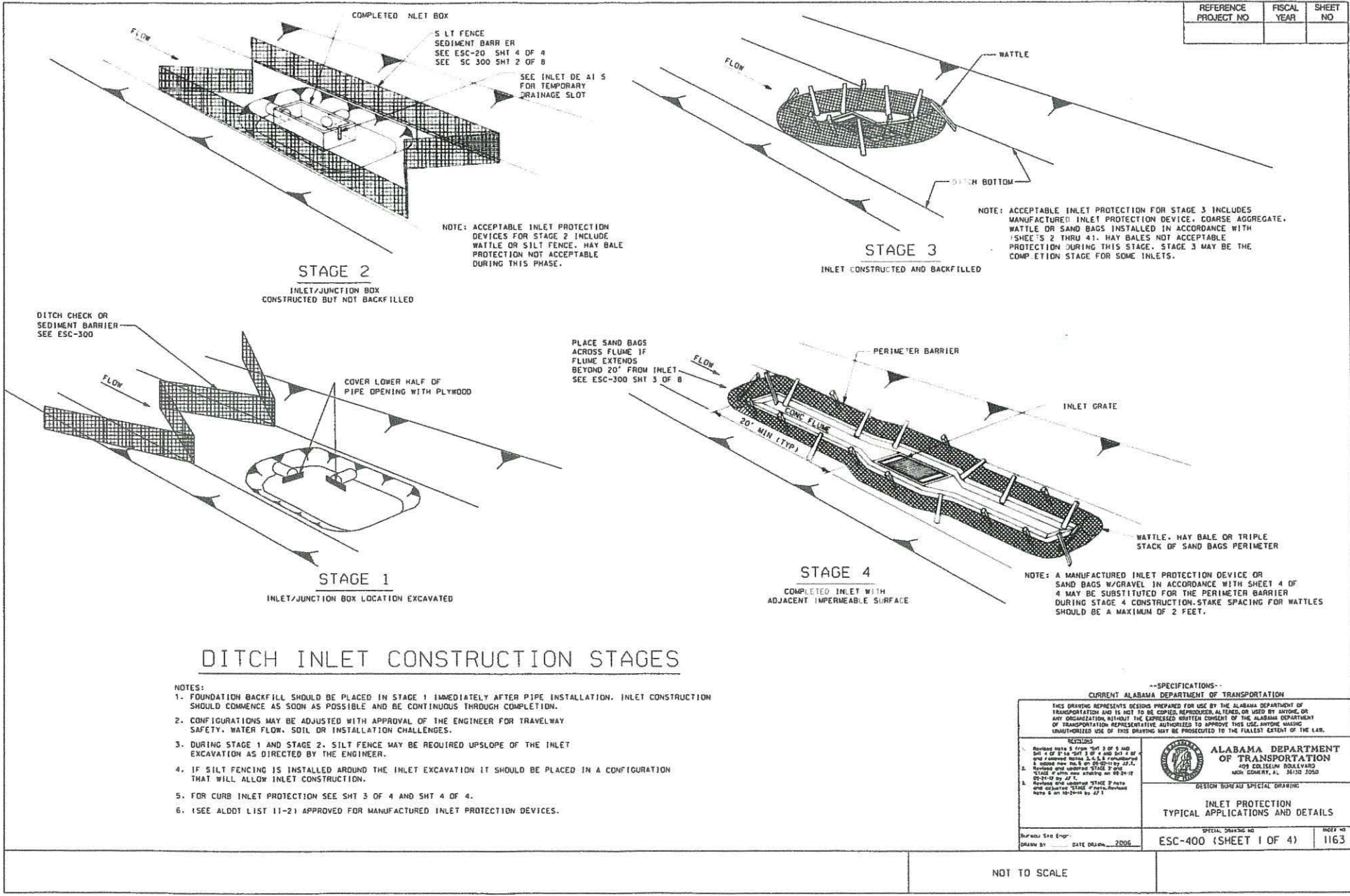

NOTE: ACCEPTABLE INLET PROTECTION DEVICES FOR STAGE 2 INCLUDE WATTLE OR SILT FENCE. HAY BALE PROTECTION NOT ACCEPTABLE DURING THIS PHASE.

NOTE: ACCEPTABLE INLET PROTECTION FOR STAGE 3 INCLUDES MANUFACTURED INLET PROTECTION DEVICE, COARSE AGGREGATE, WATTLE OR SAND BAGS INSTALLED IN ACCORDANCE WITH SHEET 2 THRU 41. HAY BALES NOT ACCEPTABLE PROTECTION DURING THIS STAGE. STAGE 3 MAY BE THE COMPLETION STAGE FOR SOME INLETS.

NOTE: A MANUFACTURED INLET PROTECTION DEVICE OR SAND BAGS W/ GRAVEL IN ACCORDANCE WITH SHEET 4 OF 4 MAY BE SUBSTITUTED FOR THE PERIMETER BARRIER DURING STAGE 4 CONSTRUCTION. STAKE SPACING FOR WATTLES SHOULD BE A MAXIMUM OF 2 FEET.

DITCH INLET CONSTRUCTION STAGES

- NOTES:
1. FOUNDATION BACKFILL SHOULD BE PLACED IN STAGE 1 IMMEDIATELY AFTER PIPE INSTALLATION. INLET CONSTRUCTION SHOULD COMMENCE AS SOON AS POSSIBLE AND BE CONTINUOUS THROUGH COMPLETION.
 2. CONFIGURATIONS MAY BE ADJUSTED WITH APPROVAL OF THE ENGINEER FOR TRAVELWAY SAFETY, WATER FLOW, SOIL OR INSTALLATION CHALLENGES.
 3. DURING STAGE 1 AND STAGE 2, SILT FENCE MAY BE REQUIRED UPSLOPE OF THE INLET EXCAVATION AS DIRECTED BY THE ENGINEER.
 4. IF SILT FENCING IS INSTALLED AROUND THE INLET EXCAVATION IT SHOULD BE PLACED IN A CONFIGURATION THAT WILL ALLOW INLET CONSTRUCTION.
 5. FOR CURB INLET PROTECTION SEE SHT 3 OF 4 AND SHT 4 OF 4.
 6. (SEE ALODI LIST 11-2) APPROVED FOR MANUFACTURED INLET PROTECTION DEVICES.

--SPECIFICATIONS--

CURRENT ALABAMA DEPARTMENT OF TRANSPORTATION

THIS DRAWING REPRESENTS DESIGNS PREPARED FOR USE BY THE ALABAMA DEPARTMENT OF TRANSPORTATION AND IS NOT TO BE COPIED, REPRODUCED, ALTERED, OR USED BY ANYONE OR ANY ORGANIZATION WITHOUT THE EXPRESSED WRITTEN CONSENT OF THE ALABAMA DEPARTMENT OF TRANSPORTATION REPRESENTATIVE AUTHORIZED TO APPROVE THIS USE. ANYONE MAKING UNAUTHORIZED USE OF THIS DRAWING MAY BE PROSECUTED TO THE FULLEST EXTENT OF THE LAW.

<p>REVISIONS</p> <p>1. REVISED SHEET 1 FROM SHT 3 OF 4 AND SHT 4 OF 4 TO SHT 1 OF 4 AND SHT 2 OF 4 AND A REVISED SHEET 3 OF 4 FROM SHEET 3 OF 4 AND SHEET 4 OF 4 BY 2212.</p> <p>2. REVISED SHEET 2 FROM SHT 2 OF 4 TO SHEET 2 OF 4 AND SHEET 3 OF 4 BY 2212.</p> <p>3. REVISED SHEET 4 FROM SHT 4 OF 4 TO SHEET 4 OF 4 AND SHEET 5 OF 4 BY 2212.</p> <p>4. REVISED SHEET 5 FROM SHT 5 OF 4 TO SHEET 5 OF 4 AND SHEET 6 OF 4 BY 2212.</p> <p>5. REVISED SHEET 6 FROM SHT 6 OF 4 TO SHEET 6 OF 4 AND SHEET 7 OF 4 BY 2212.</p>	<p>ALABAMA DEPARTMENT OF TRANSPORTATION 409 COLLEMAN BOULEVARD MONTGOMERY, AL 36102-0000</p> <p>DESIGN: BUREAU SPECIAL DRAWING</p> <p>INLET PROTECTION TYPICAL APPLICATIONS AND DETAILS</p> <p>SPECIAL DRAWING NO. ESC-400 (SHEET 1 OF 4)</p>	<p>DATE DRAWN: 2006</p> <p>DATE: 2006</p>	<p>SHEET NO. 1163</p>
---	---	---	-----------------------

NOT TO SCALE